



HEAVY DUTY SPLIT SHAFT PTOs

PROBLEM:

Your Auxiliary Power Requirements Exceed Your Transmission PTO Options

SOLUTION:

"Muncie Heavy Duty Split Shaft PTOs"
SSV2 (vertical) and
SSH2 (horizontal)

- Through torque to 21,600 lb-ft.
- Output torque to 936 lb-ft.
- 1410 or 1500 Series companion flange outputs
- 1550, 1600, 1700, 1800 Series main shaft flanges
- SAE "B", "B-B", "C", "C-C" and "D" hydraulic mounts
- Air-shift operation
- Suitable for stationary or mobile applications
- Precision ground gearing for quiet operation

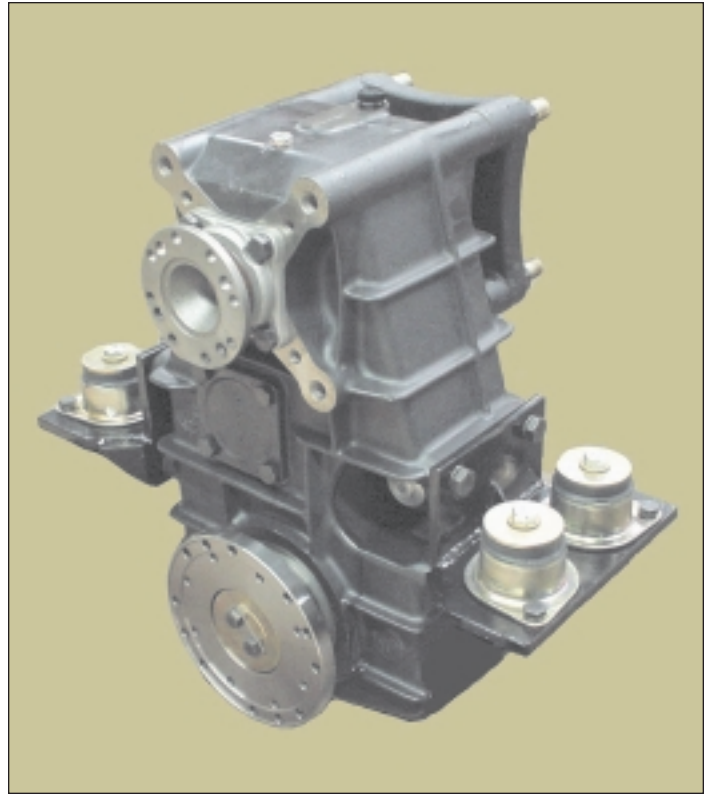



HEAVY DUTY SPLIT SHAFT PTOS INSTALLATION DIMENSIONS

SSV2

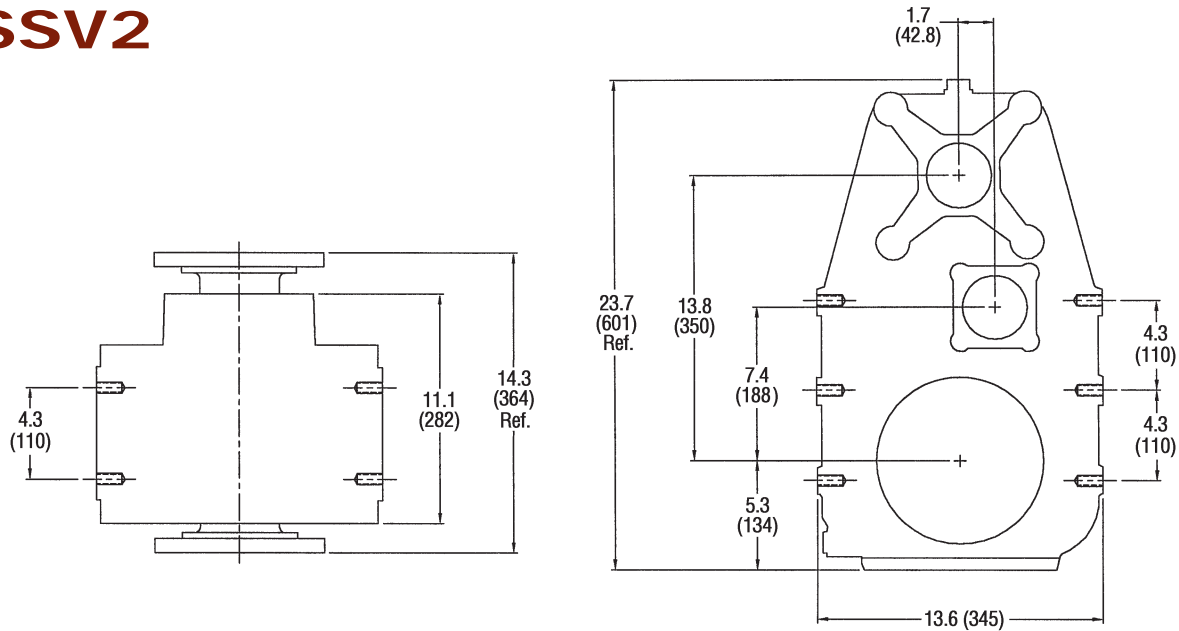

SSH2

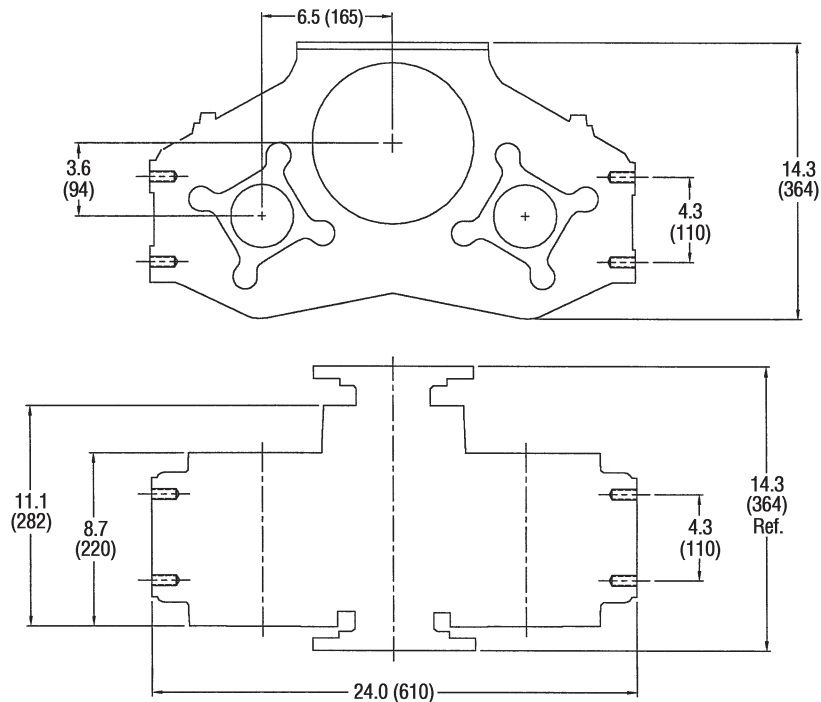

**Muncie®
Power
Products**

MP03-03 Printed in the U.S.A.
© Muncie Power Products, Inc. 2003

Muncie Power Products, Inc. Member of the Interpump Hydraulics Group
General Offices and Distribution Center • P.O. Box 548 • Muncie, IN 47308-0548
(765) 284-7721 • FAX (765) 284-6991 • E-mail info@munciepower.com
Web site <http://www.munciepower.com>

Drive Products, Inc., Toronto, Exclusive Agents for Canada, a Non-ISO Registered Firm

